

# Standalone Presence Detectors

Innovation. Functionality. Simplicity.







## Contents

### Infrared Handsets



#### UNLCDHS

Professional programming/  
commissioning LCD handset

4



#### UHS5

Compact programming/  
commissioning handset

4



#### UHS7

Compact user handset

4

### PIR Presence Detectors



#### EBDSPIR

Compact, flush mounted detectors

5



#### EBDSM

Compact, surface mounted  
detectors

6



#### EBDMR

Mid range, flush mounted detectors

7



#### EBMHS

Miniature, flush mounted detectors

8



#### EBMPIR-MB

Miniature, retrofit, luminaire  
mounted detectors

9



#### EBMINT

Miniature, retrofit, luminaire  
mounted detectors

10



#### EBDRC

Adjustable head, flush mounted  
detectors

11

## Innovation. Functionality. Simplicity.

Our wide range of PIR and microwave presence detectors are designed to reduce the amount of time lighting is left on unnecessarily – for example if an area is unoccupied or if there is sufficient natural light.

Controlling lighting with a presence detector can save up to 60% of lighting energy costs dependent on occupancy behaviour and the amount of natural light available. Our PIR and microwave presence detectors can also be used to control heating and ventilation.

In our range you are sure to find a presence detector that will suit any area.



## PIR Presence Detectors



### EBDHS

Long range, flush mounted detectors

12



### EBDHS-MB

Long range, luminaire mounted detectors

13

## Air Conditioning Controller



### GESM-AC

Surface mounted controller for air conditioning

14

## Microwave Presence Detectors



### MWS3A

Adjustable head, flush mounted detectors

15



### MWS5

Compact, flush / surface mounted detectors

16



### MWS6

Compact, flush mounted detectors

17



### MWS6SM

Compact, surface mounted detectors

18



### MWS1A

Low profile, back box mounted detectors

19



### MWS1A-IP

Rugged, surface mounted detectors

20

## Light Level Controls



### ALC

Compact, flush mounted photocell switches

21

## Product Spotlight



### Low Temperature Detectors

22



### KNX Presence Detection

22

## Technology Guide

Presence and absence detection explained

23

PIRs and microwave detectors compared

23

PRM Detectors – switching with lux level sensing

24

DD & AD Detectors – dimming with lux level sensing

25

## Order Codes

26

## Infrared Handsets

Our range of infrared (IR) handsets have been designed to allow simple configuration, programming and maximum user convenience.

There's a handset to suit every user, whether it's the commissioning engineer configuring hundreds of detectors, a contractor setting up two or three, or a user who simply wishes to override a setting or switch between pre-programmed scenes.



### UNLCDHS – Professional commissioning LCD programming handset

- The UNLCDHS is used for the operation, configuration and programming of CP products that have the ability to be programmed via IR. These include the PRM, DD, AD, Vitesse Plus, RAPID, D-Mate and An-10 ranges.
- IR range up to 20m.



### UHS5 – Commissioning handset

- The UHS5 is a compact infrared handset used for the basic programming of IR enabled CP products
- IR range up to 7m.

### UHS7 – User handset

- User handset for simple scene setting, on & off, raise & lower
- IR range up to 7m.



## EBDSPIR | Compact, flush mounted detectors



This compact ceiling mounted PIR presence detector provides automatic control of lighting, heating and ventilation loads.

- Low profile design
- Self contained unit
- Pluggable
- Infrared programmable.

### Detection pattern

high < sensitivity > low

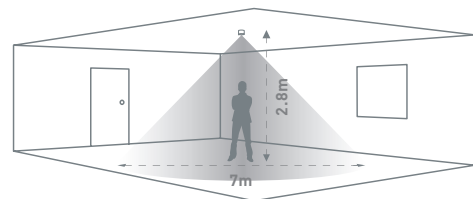

### Available control methods

- PRM – Switching
- DD – DALI/DSI dimming
- AD – Analogue dimming
- KNX

### Available options

- LT30 – Low temperature
- LV – Low voltage
- VFC – Voltage free contact
- 2CH – 2 channel
- 2CH-NC – 2 channel normally closed for fail safe applications

### Dimensions (mm)

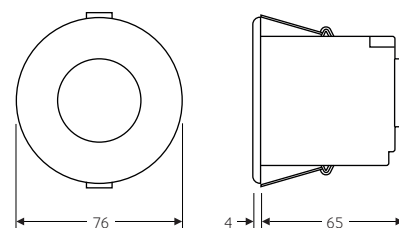

## EBDSM | Compact, surface mounted detectors



This range of surface mounted PIR presence detectors is perfect for simple attachment when flush mounting is not possible.

- Self contained unit
- Easy to install via back plate
- Infrared programmable
- IP40 (no gasket); IP54 when fitted with gasket.

### Available control methods

- PRM – Switching
- DD – DALI/DSI dimming
- AD – Analogue dimming

### Detection pattern

high < sensitivity > low

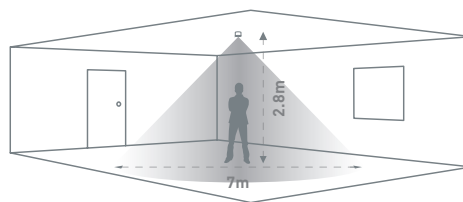

### Dimensions (mm)

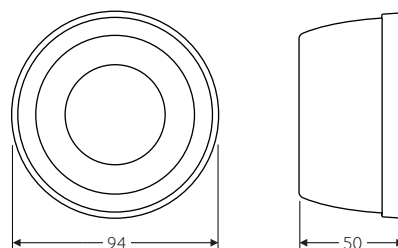

## EBDMR | Mid range, flush mounted detectors



Our range of compact flush mounted PIR detectors with high performance faceted lens is suitable for use in open spaces or where a larger detection range is required.

- Mid range lens with concentric lens facets for improved detection
- 360° presence and absence detector
- Ideal for open spaces
- IP40 rated
- Available in a wide range of RAL colours.

### Available control methods

- PRM – Switching
- DD – DALI/DSI dimming
- AD – Analogue dimming

### Detection pattern

high < sensitivity > low

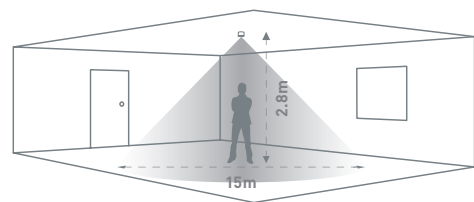

### Dimensions (mm)

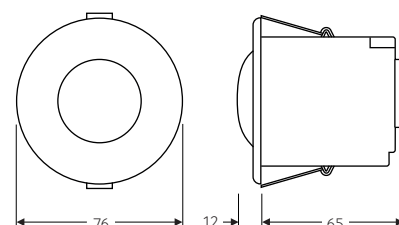



## EBMHS | Miniature, flush/surface mounted detectors



This small, unobtrusive, but highly capable PIR detector is supplied pre-wired and with a connector that snap-fits into the power supply unit (PSU) for ease of installation.

- Small and unobtrusive design
- High sensitivity head for increased detection range
- Supplied pre-wired with an RJ11 plug for connection into the power supply
- Infrared programmable
- For mounting at heights up to 7m
- Supplied with a flush mounting ring for easy fitting into the ceiling.

### Available control methods

- PRM – Switching
- DD – DALI/DSI dimming
- AD – Analogue dimming

### Available options

- LV – Low voltage

### Detection pattern

high < sensitivity > low

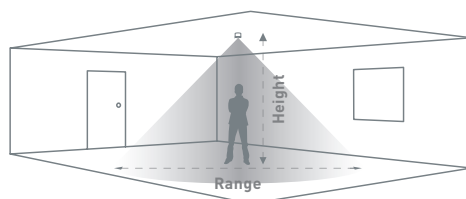

Height	Range
2.8m	9m
7m	16m

### Dimensions (mm)

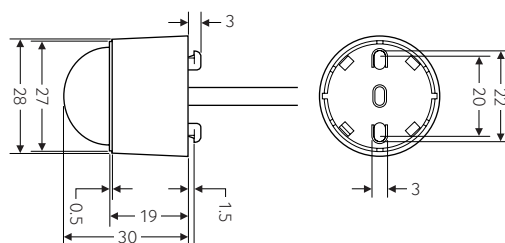



## EBMPIR-MB | Miniature, retrofit, luminaire mounted detectors



The EBMPIR-MB series of batten mount PIR presence detectors have been designed specifically for mounting on to a batten style luminaire.

- Batten mount retrofit solution
- Integrated power supply
- Suitable for a wide range of luminaires
- Supplied with 1m lead
- IP65 rated for wet and damp environments
- For mounting at heights up to 7m.

### Available control methods

- PRM – Switching
- DD – DALI/DSI dimming
- AD – Analogue dimming

### Available options

- LT30 – Low temperature
- LV – Low voltage (110V)

### Detection pattern

high < sensitivity > low

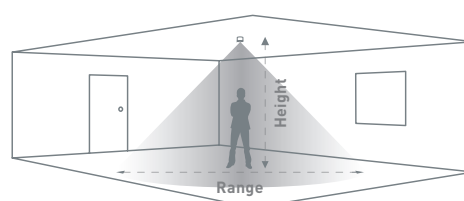

Height	Range
2.8m	9m
7m	16m

### Dimensions (mm)

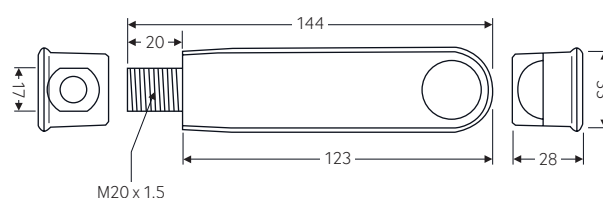

## EBMINT | Miniature clip on, retrofit, luminaire mounted detectors



The patented series of miniature PIR presence detectors is designed to be retrofitted to luminaires quickly and effectively.

- Sensitive movement detection up to 7m
- Fixings for T5, T8 battens and louvre reflectors
- Easy to install – no specialist tools required
- Quick to set up via infrared handset control
- Integrated power supply.

### Available control methods

- PRM – Switching
- DD – DALI/DSI dimming
- AD – Analogue dimming

### Detection pattern

high < sensitivity > low

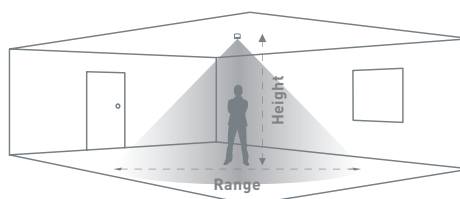

Height	Range
2.8m	9m
7m	16m

### Dimensions (mm)

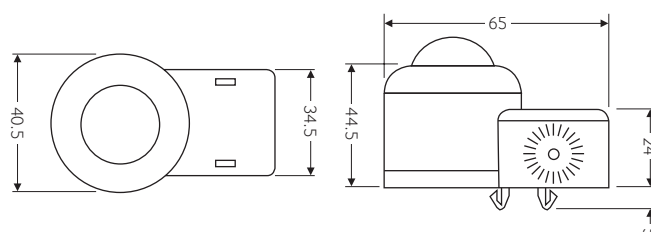

## EBDRC | Adjustable head, flush mounted detectors



**Head can be adjusted to suit the detection pattern required**



Detection head position set to 15°



Detection head position set to 90°



The EBDRC PIR series contains an adjustable head, and is fitted with a curtain lens for long range detection. Our directional PIR is suitable for mounting in aisleway and corridor applications where a long narrow detection pattern is required.

- Adjustable head
- Curtain lens for longer detection range
- Lux and time control
- IP40 rated
- Ideal for corridor applications.

### Available control methods

- PRM – Switching
- DD – DALI/DSI dimming
- AD – Analogue dimming

### Detection pattern

high < sensitivity > low

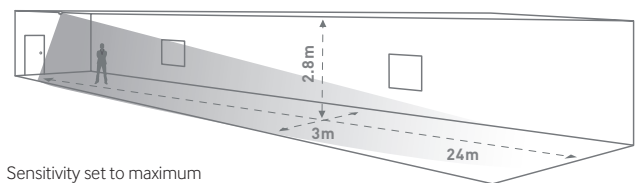

Sensitivity set to maximum  
Detector head position set to 90°

### Dimensions (mm)

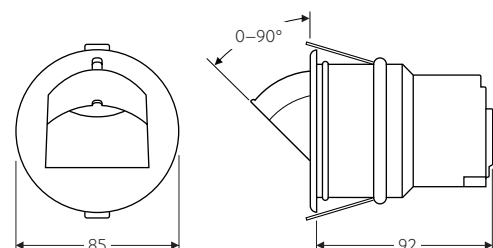



## EBDHS | Long range, flush mounted, high level detectors



The EBDHS PIR presence detector is developed for lighting control in areas with demanding spaces and increased mounting heights.

- Ground breaking detection range
- For mounting at heights up to 20m depending on operating parameters
- Unique lens technology – high sensitivity
- Ideal for high level/high bay applications
- Supplied with adjustable masking shields to tailor detection zones.

### Detection pattern

high < sensitivity > low

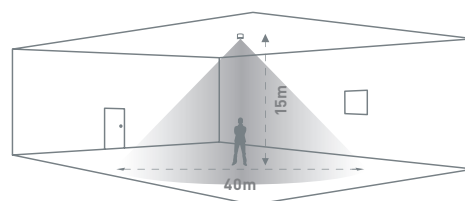

### Available control methods

- PRM – Switching
- DD – DALI/DSI dimming
- AD – Analogue dimming
- KNX

### Available options

- LT30 – Low temperature
- LV – Low voltage

### Dimensions (mm)

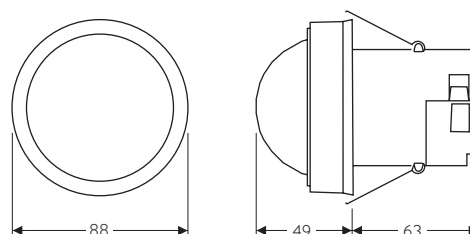

## EBDHS-MB | Long range, luminaire mounted, high level detectors



The EBDHS-MB luminaire mounted PIR presence detector range provides exceptionally sensitive and long range detection. Ideal for high bay lighting control in areas with demanding spaces and increased mounting heights.

- Ground breaking detection range
- For mounting at heights up to 20m depending on operating parameters
- Unique lens technology – high sensitivity
- Ideal for high level/high bay applications
- Easy to retrofit to commercial luminaires and basic battens.

### Available control methods

- PRM – Switching
- DD – DALI/DSI dimming
- AD – Analogue dimming

### Available options

- LT30 – Low temperature

### Detection pattern

high < sensitivity > low

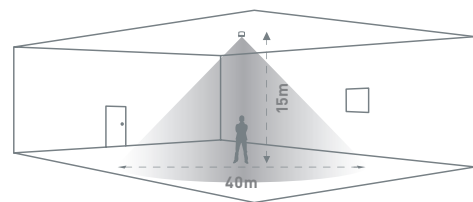

### Dimensions (mm)

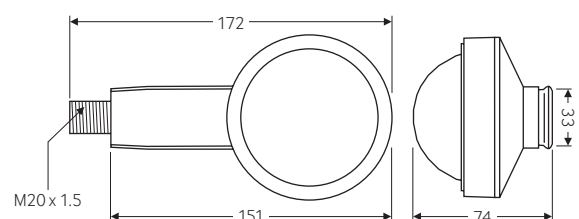

## GESM-AC | Surface mounted controller for air conditioning



A surface mounted air conditioning (AC) controller that provides auto on/auto off switching of infrared controlled AC units, based on occupancy. As it controls use, significant energy savings can be achieved.

Battery powered and quick to install, the timeout period of the GESM-AC can be easily set up via push button operation.

- Automatic control of air conditioning
- Compatible with most infrared controlled AC units
- Adjustable via easy push button operation
- Learn mode – works by 'learning' the infrared code and overriding the on/off commands
- Sleep mode – extended battery life by 'waking up' on detection
- Ideal for small meeting rooms, holiday lets, classrooms, health centres and care homes
- Supplied with two AA batteries.

### Detection pattern

high < sensitivity > low

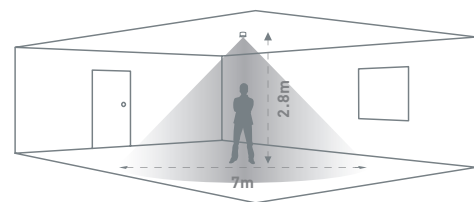

### Dimensions (mm)

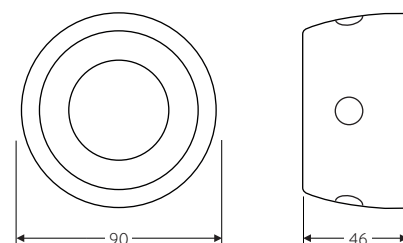



## MWS3A | Adjustable head, flush mounted detectors



Unlike fixed head microwave detectors the MWS3A offers a unique presence/absence detection capability by using an adjustable head.

- Unique adjustable head design to achieve the required detection pattern
- Locking mechanism to prevent tampering
- Can be flush or surface mounted
- IP40 rated.

### Available control methods

- PRM – Switching
- DD – DALI/DSI dimming
- AD – Analogue dimming
- KNX

### Available options

- LV – Low voltage
- VFC – Voltage free contact
- 2CH – 2 channel
- 2CH-NC – 2 channel normally closed for fail safe applications



### Detection pattern

high < sensitivity > low

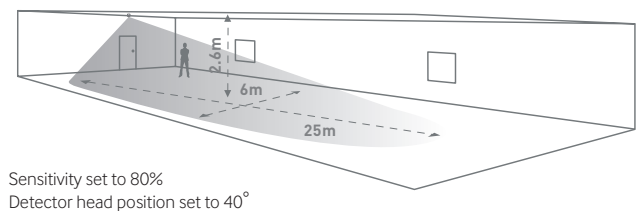
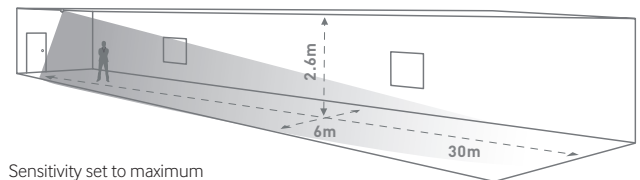
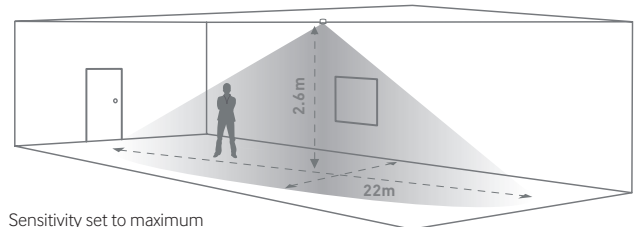

### Dimensions (mm)

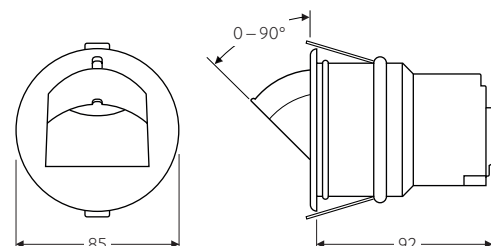

## MWS5 | Compact, flush/surface mounted detectors



The MWS5 range of compact microwave detectors has been specifically designed to be mounted within a luminaire. They are sensitive to movement and are ideal for large spaces that have an awkward shape.

- Can be flush or surface mounted
- Remote power supply allows head to be fitted in confined spaces
- Suitable for wall or ceiling mounted luminaires
- A selection of fixing clips to allow the unit to be mounted in or to the side of a luminaire is available
- Standard and slimline power supply units also available.

### Available control methods

- PRM – Switching
- DD – DALI/DSI dimming
- AD – Analogue dimming

### Available options

- LV – Low voltage

### Detection pattern

high < sensitivity > low

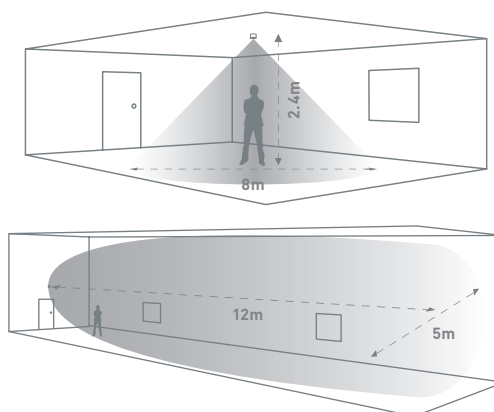

### Dimensions (mm)

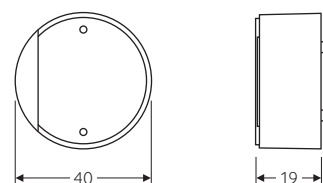

For power supply unit dimensions, please refer to the product installation guide on our website

## MWS6 | Compact, flush mounted detectors



The MWS6 is a low profile microwave presence/absence detector for the automatic control of lighting, heating and ventilation.

- Low profile design
- Self contained unit
- Pluggable
- IP40 rated
- Available in a wide range of RAL colours.

### Detection pattern

high < sensitivity > low

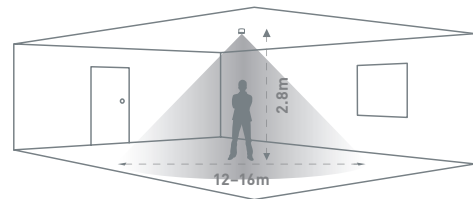

### Available control methods

- PRM – Switching
- DD – DALI/DSI dimming
- AD – Analogue dimming
- KNX

### Available options

- LV – Low voltage
- VFC – Voltage free contact
- 2CH – 2 channel
- 2CH-NC – 2 channel normally closed for fail safe applications

### Dimensions (mm)

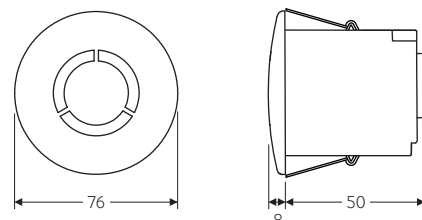



## MWS6SM | Compact, surface mounted detectors



The MWS6SM is a surface mounted mid-range microwave presence/absence detector for the automatic control of lighting, heating and ventilation.

- Surface mounted
- IP40 rated
- Self contained unit
- Easy to install via a back plate.

### Available control methods

- PRM – Switching
- DD – DALI/DSI dimming
- AD – Analogue dimming

### Detection pattern

high < sensitivity > low

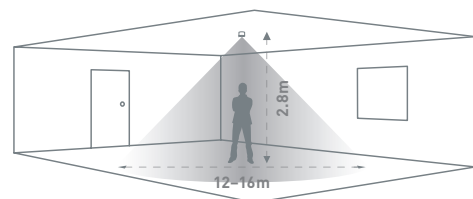

### Dimensions (mm)

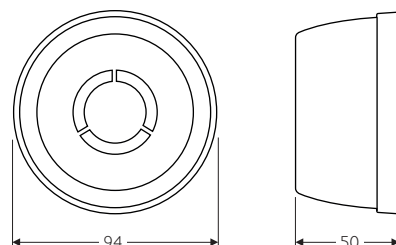

## MWS1A | Low profile, back box mounted detectors



This discrete range of wall or ceiling mounted microwave presence detectors is designed to fit out any single gang switch box.

- Presence detection
- Easily setup using the UHS5 infrared handset – no need to remove unit to re-program
- Suitable for heating and ventilation applications
- Compatible with European back boxes
- Fixing screw cap covers – smooth plate finish.

### Detection pattern

high < sensitivity > low

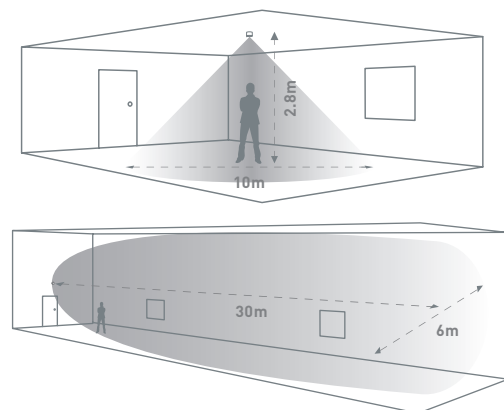

### Available control methods

- PRM – Switching

### Available options

- LV – Low voltage
- VFC – Voltage free contact

### Dimensions (mm)

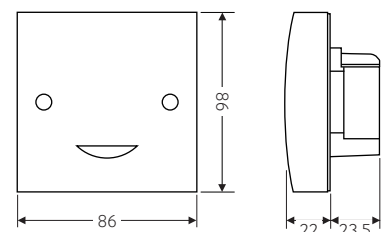

## MWS1A-IP | Rugged, surface mounted detectors



This rugged range of wall or ceiling mounted microwave detectors are rated IP66 - suitable for use in damp environments.

- Unobtrusive design – vandal resistant
- Built in lux level sensing – enhanced energy saving
- Low voltage and volt free options – suitable for BMS and other control applications.

### Detection pattern

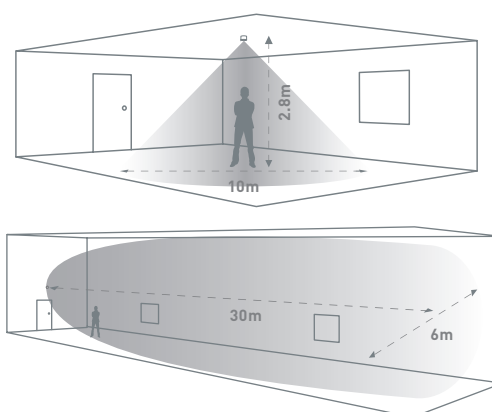

### Available control methods

- PRM – Switching

### Available options

- LV – Low voltage
- VFC – Volt free contact

### Dimensions (mm)

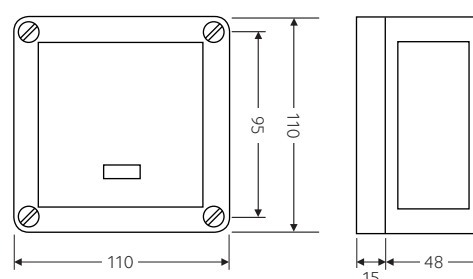



## ALC | Compact, flush mounted photocell switches



The ALC is a flush mounted lighting control photocell for the automatic control of light output from suitable luminaires.

- Flush or surface mounted
- Adjustable preset levels for more control
- Adjustable time delay prevents nuisance switching
- Dimming version available to provide a maintained level of illuminance.

### Available control methods

- DD – DALI/DSI dimming
- AD – Analogue dimming

### Dimensions (mm)

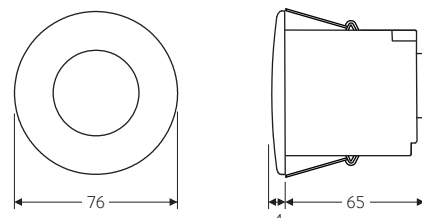

## Low Temperature Detectors

Following rigorous testing in climatic chambers and on-site, our Minus30 range of lighting controls is specifically designed for the cold storage and refrigeration sector, performing down to aggressive -30° temperatures.



EBMPIR-MB-LT30



EBDSPIR-LT30



EBDHS-LT30



EBDHS-MB-LT30

## KNX Presence Detectors

CP Electronics brings its extensive functionality to KNX, the worldwide standard for unifying all communication between intelligent devices that light, heat and ventilate homes and buildings.

### Key features:

- Presence detector, either PIR or microwave
- Absence detection
- Walk test LED
- Light level sensor
- Two ELV switch inputs
- User-configurable logic functions and timers.

Configuration of devices on the KNX bus takes place via the standard ETS software application, allowing all aspects of the presence detector's behavior to be configured and controlled.



EBDSPIR-KNX



EBDHS-KNX



MWS3A-KNX



MWS6-KNX

## Presence and absence detection explained



**Presence Detection:** Detectors will switch on lighting automatically when a person enters the room, and switches off lighting automatically when no movement is detected.



**Absence Detection:** Upon entering the room the person switches on the light as normal, but on leaving the detector switches off the lighting automatically. Lights can also be switched off manually.

## PIRs and microwave detectors compared

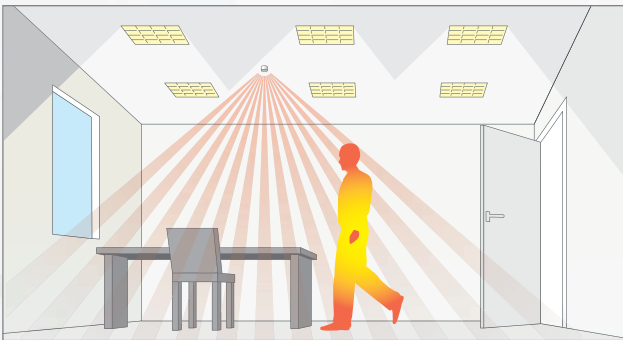

**PIR (Passive Infrared) Detection:** PIR detectors work on detecting the movement of body heat. They are better suited to smaller spaces or where a defined detection pattern is required.

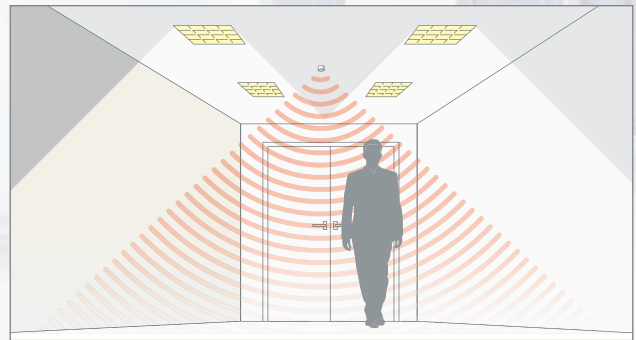

**Microwave Detection:** Microwave Detectors are sensitive to objects that move, with much greater coverage and sensitivity. They can detect through glass, therefore careful consideration on location is needed in certain applications.



## PRM Detectors | Switching with lux level sensing

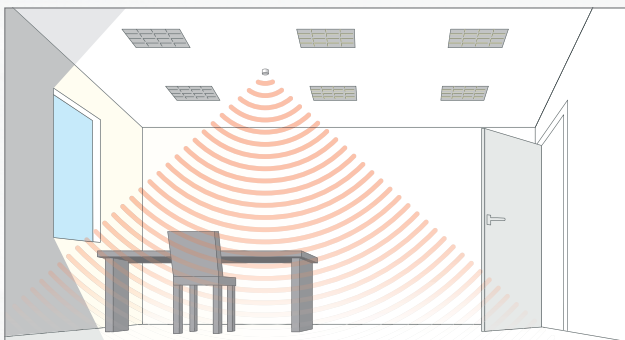

No presence detected, daylight, lights off.

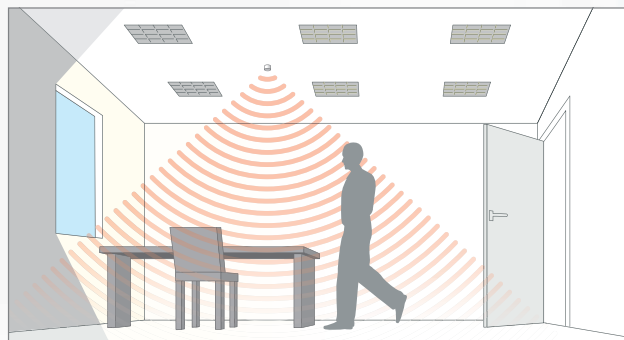

Presence detected, sufficient daylight, lights off.

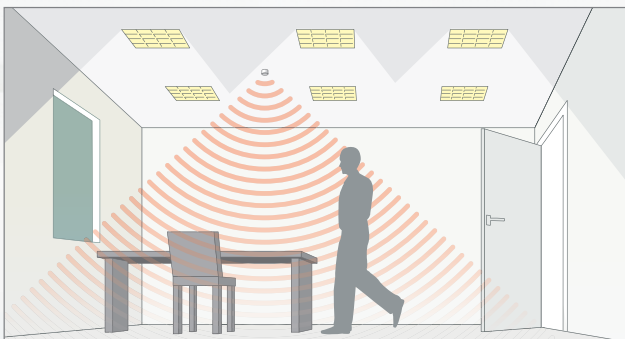

Presence detected, insufficient daylight, all lights on.

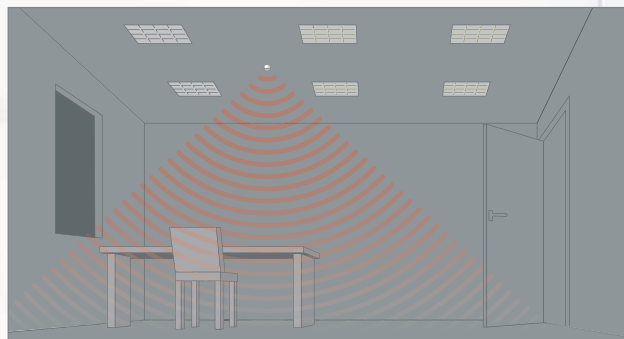

No presence detected, lights off.

These presence detectors have built-in adjustable lux sensors which will keep the lighting switched off if there is sufficient natural light.

### Key features

- Switching with lux level sensing (infrared handset adjustment)
- Active photocell
- Time delay function
- Presence detection switching.
- Absence detection switching
- Programmable via Infrared handset
- Adjustable detection sensitivity
- On/off override via optional Infrared handset
- Manual on/off override via switch input.

## DD & AD Detectors | Dimming with lux level sensing

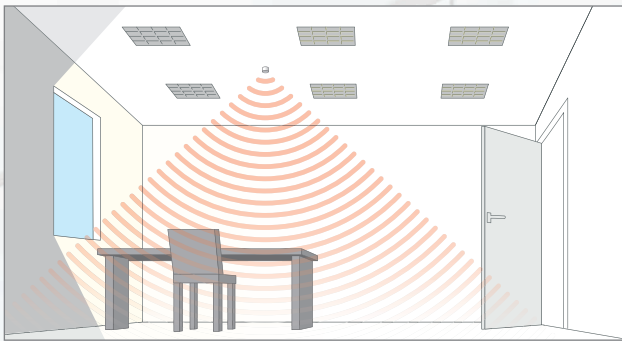

No presence detected, daylight, lights off.

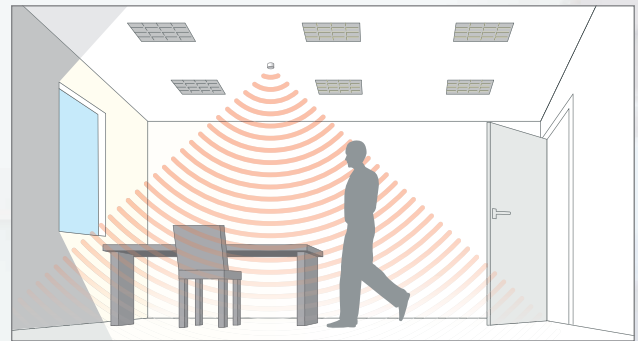

Presence detected, sufficient daylight, lights off.

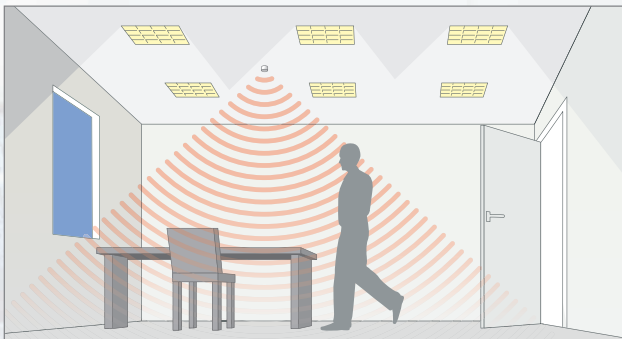

Presence detected, some daylight. Lights on and dimmed to maintain lux level.

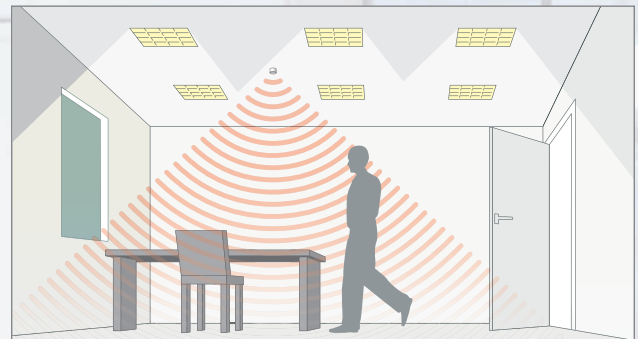

Presence detected, insufficient daylight. Detector measures and implements maintained illuminance.

These presence detectors have built-in adjustable lux sensors which will keep the lighting switched off if there is sufficient natural light.





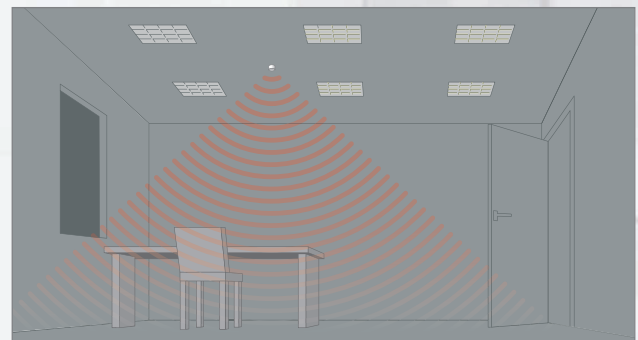

### Key features (in addition to PRM detectors)

- Dimming functionality
- Two channel flexibility
- Step-down illuminance
- Maintained illuminance (daylight harvesting)
- Scene setting and recall
- Burn in feature for fluorescent tubes
- Control of DALI, DSI or 1–10V loads depending on product
- Integral relay to reduce parasitic power
- Suitable for all lighting types
- Manual dimming with infrared
- Manual dimming with switch inputs.



No presence detected, lights off.

## Ceiling Mounted PIR Presence Detectors



	Order Code	Description	PG
	<b>EBDSPIR-AD</b>	1–10V analogue dimming, compact, IP40, ceiling, flush mounted, PIR, presence/absence detector, up to 10 drivers/ballasts	5
	<b>EBDSPIR-DD</b>	DALI/DSI digital dimming, compact, IP40, ceiling, flush mounted, PIR, presence/absence detector, up to 20 drivers/ballasts	
	<b>EBDSPIR-DD-LV</b>	DALI/DSI digital dimming, compact, IP40, ceiling, flush mounted, PIR, presence/absence detector, low voltage, up to 10 drivers/ballasts	
	<b>EBDSPIR-PRM</b>	PRM switching, compact, IP40, ceiling, flush mounted, PIR, presence/absence detector	
	<b>EBDSPIR-PRM-2CH</b>	PRM switching, compact, IP40, ceiling, flush mounted, PIR, presence/absence detector, 2-channel	
	<b>EBDSPIR-PRM-2CH-NC</b>	PRM switching, compact, IP40, ceiling, flush mounted, PIR, presence/absence detector, normally closed fail-safe contacts, 2-channel	
	<b>EBDSPIR-PRM-IP</b>	PRM switching, compact, IP55, ceiling, flush mounted, PIR, presence/absence detector	
	<b>EBDSPIR-PRM-L3</b>	PRM switching, compact, IP40, ceiling, flush mounted, PIR, presence/absence detector, c/w 3m lead	
	<b>EBDSPIR-PRM-LV</b>	PRM switching, compact, IP40, ceiling, flush mounted, PIR, presence/absence detector, low voltage	
	<b>EBDSPIR-PRM-VFC</b>	PRM switching, compact, IP40, ceiling, flush mounted, PIR, presence/absence detector, volt free contacts	
	<b>EBDSM-AD</b>	1–10V analogue dimming, compact, IP40 without gasket; IP54 with gasket, ceiling, surface mounted, PIR, presence/absence detector, up to 10 drivers/ballasts	6
	<b>EBDSM-DD</b>	DALI/DSI digital dimming, compact, IP40 without gasket; IP54 with gasket, ceiling, surface mounted, PIR, presence/absence detector, up to 20 drivers/ballasts	
	<b>EBDSM-PRM</b>	PRM switching, compact, IP40 without gasket; IP54 with gasket, ceiling, surface mounted, PIR, presence/absence detector	
	<b>EBMHS-AD-SA-C</b>	1–10V analogue dimming, miniature, IP40, ceiling, flush/surface mounted, PIR, presence/absence detector, c/w pre-wired PSU, up to 10 drivers/ballasts	8
	<b>EBMHS-DD-SA-C</b>	DALI/DSI digital dimming, miniature, IP40, ceiling, flush/surface mounted, PIR, presence/absence detector, c/w pre-wired PSU, up to 10 drivers/ballasts	
	<b>EBMHS-PRM-SA-C</b>	PRM switching, miniature, IP40, ceiling, flush/surface mounted, PIR, presence/absence detector, c/w pre-wired PSU, up to 10 drivers/ballasts	
	<b>EBMINT-AD</b>	1–10V analogue dimming, miniature clip on, retrofit, IP40, ceiling, luminaire mounted, PIR, presence detector, up to 4 drivers/ballasts	10
	<b>EBMINT-DD</b>	DALI/DSI digital dimming, miniature clip on, retrofit, IP40, ceiling, luminaire mounted, PIR, presence detector, up to 4 drivers/ballasts	
	<b>EBMINT-PRM</b>	PRM switching, miniature clip on, retrofit, IP40, ceiling, luminaire mounted, PIR, presence detector, up to 4 drivers/ballasts	
	<b>EBMPIR-MB-AD</b>	1–10V analogue dimming, miniature, retrofit, IP65, ceiling, luminaire mounted, PIR, presence detector, up to 4 drivers/ballasts	9
	<b>EBMPIR-MB-DD</b>	DALI/DSI digital dimming, miniature, retrofit, IP65, ceiling, luminaire mounted, PIR, presence detector, up to 10 drivers/ballasts	
	<b>EBMPIR-MB-PRM</b>	PRM switching, miniature, retrofit, IP65, ceiling, luminaire mounted, PIR, presence detector	
	<b>EBMPIR-MB-PRM-110</b>	PRM switching, miniature, retrofit, IP65, ceiling, luminaire mounted, PIR, presence detector, 110V	
	<b>EBDMR-AD</b>	1–10V analogue dimming, mid range, IP40, flush mounted, ceiling, PIR, presence/absence detector	7
	<b>EBDMR-DD</b>	DALI/DSI digital dimming, mid range, IP40, flush mounted, ceiling, PIR, presence/absence detector	
	<b>EBDMR-PRM</b>	PRM switching, mid range, IP40, flush mounted, ceiling, PIR, presence/absence detector	
	<b>EBDRC-AD</b>	1–10V analogue dimming, adjustable head, IP40, flush mounted, ceiling, PIR, presence/absence detector	11
	<b>EBDRC-DD</b>	DALI/DSI digital dimming, adjustable head, IP40, flush mounted, ceiling, PIR, presence/absence detector	
	<b>EBDRC-PRM</b>	PRM switching, adjustable head, IP40, flush mounted, ceiling, PIR, presence/absence detector	

## Air Conditioning Controller







	Order Code	Description	PG
	<b>GESM-AC</b>	Compact, surface mounted, ceiling, AC detector	14





## High Level PIR Presence Detectors

	Order Code	Description	PG
	<b>EBDHS-AD</b>	1–10V analogue dimming, long range, IP65, high level, flush mounted, PIR, presence/absence detector, up to 10 drivers/ballasts	12
	<b>EBDHS-DD</b>	DALI/DSI digital dimming, long range, IP65, high level, flush mounted, PIR, presence/absence detector, up to 20 drivers/ballasts	
	<b>EBDHS-PRM</b>	PRM switching, long range, IP65, high level, flush mounted, PIR, presence/absence detector	
	<b>EBDHS-MB-AD</b>	1–10V analogue dimming, long range, retrofit, IP65, high level, luminaire mounted, PIR, presence detector, up to 4 drivers/ballasts	13
	<b>EBDHS-MB-DD</b>	DALI/DSI digital dimming, long range, retrofit, IP65, high level, luminaire mounted, PIR, presence detector, up to 10 drivers/ballasts	
	<b>EBDHS-MB-PRM</b>	PRM Switching, long range, retrofit, IP65, high level, luminaire mounted, PIR, presence detector	





## Ceiling Mounted Microwave Presence Detectors

	Order Code	Description	PG
	<b>MWS1A-C-IP-PRM</b>	PRM switching, rugged, IP66, ceiling, surface mounted, microwave, presence detector	20
	<b>MWS1A-C-IP-PRM-LV</b>	PRM switching, rugged, IP66, ceiling, surface mounted, microwave, presence detector, low voltage	
	<b>MWS1A-C-IP-PRM-VFC</b>	PRM switching, rugged, IP66, ceiling, surface mounted, microwave, presence detector, volt free contacts, up to 6 drivers/ballasts	
	<b>MWS1A-C-PRM</b>	PRM switching, low profile, ceiling, back box mounted, microwave, presence detector	19
	<b>MWS1A-C-PRM-LV</b>	PRM switching, low profile, ceiling, back box mounted, microwave, presence detector, low voltage	
	<b>MWS1A-C-PRM-VFC</b>	PRM switching, low profile, ceiling, back box mounted, microwave, presence detector, volt free contacts	
	<b>MWS3A-AD</b>	1–10V analogue dimming, adjustable head, IP40, ceiling, flush mounted, microwave, presence/absence detector, up to 10 drivers/ballasts	15
	<b>MWS3A-AD-LV</b>	1–10V analogue dimming, adjustable head, IP40, ceiling, flush mounted, microwave, presence/absence detector, low voltage	
	<b>MWS3A-DD</b>	DALI/DSI digital dimming, adjustable head, IP40, ceiling, flush mounted, microwave, presence/absence detector, up to 20 drivers/ballasts	
	<b>MWS3A-DD-LV</b>	DALI/DSI digital dimming, adjustable head, IP40, ceiling, flush mounted, microwave, presence/absence detector, low voltage, up to 10 drivers/ballasts	
	<b>MWS3A-PRM</b>	PRM switching, adjustable head, IP40, ceiling, flush mounted, microwave, presence/absence detector	
	<b>MWS3A-PRM-L3</b>	PRM switching, adjustable head, IP40, ceiling, flush mounted, microwave, presence/absence detector, c/w 3m lead	
	<b>MWS3A-PRM-LV</b>	PRM switching, adjustable head, IP40, ceiling, flush mounted, microwave, presence/absence detector, low voltage	
	<b>MWS3A-PRM-VFC</b>	PRM switching, adjustable head, IP40, ceiling, flush mounted, microwave, presence/absence detector, volt free contacts	
	<b>MWS5-AD-SA-C</b>	1–10V analogue dimming, compact, IP40, ceiling, flush mounted, microwave, presence/absence detector	16
	<b>MWS5-DD-SA-C</b>	DALI/DSI digital dimming, compact, IP40, ceiling, flush mounted, microwave, presence/absence detector, c/w pre-wired PSU, up to 10 drivers/ballasts	
	<b>MWS5-PRM-SA-C</b>	PRM switching, compact, IP40, ceiling, flush mounted, microwave, presence/absence detector, c/w pre-wired PSU	
	<b>MWS6-AD</b>	1–10V analogue dimming, compact, IP40, ceiling, flush mounted, microwave, presence/absence detector, up to 10 drivers/ballasts	17
	<b>MWS6-DD</b>	DALI/DSI digital dimming, compact, IP40, ceiling, flush mounted, microwave, presence/absence detector, up to 20 drivers/ballasts	
	<b>MWS6-PRM</b>	PRM switching, compact, IP40, ceiling, flush mounted, microwave, presence/absence detector	
	<b>MWS6-PRM-2CH</b>	PRM switching, compact, IP40, ceiling, flush mounted, microwave, presence/absence detector, 2-channel	
	<b>MWS6-PRM-LV</b>	PRM switching, compact, IP40, ceiling, flush mounted, microwave, presence/absence detector, low voltage	
	<b>MWS6-PRM-VFC</b>	PRM switching, compact, IP40, ceiling, flush mounted, microwave, presence/absence detector, volt free contacts	
	<b>MWS6SM-AD</b>	1–10V analogue dimming, compact, IP40, ceiling, surface mounted, microwave, presence/absence detector, up to 10 drivers/ballasts	18
	<b>MWS6SM-DD</b>	DALI/DSI digital dimming, compact, IP40, ceiling, surface mounted, microwave, presence/absence detector, up to 20 drivers/ballasts	
	<b>MWS6SM-PRM</b>	PRM switching, compact, IP40, ceiling, surface mounted, microwave, presence/absence detector	





## Wall Mounted Microwave Presence Detectors

	Order Code	Description	PG
	<b>MWS1A-IP-PRM</b>	PRM switching, rugged, IP66, wall, surface mounted, microwave, presence detector	20
	<b>MWS1A-IP-PRM-LV</b>	PRM switching, rugged, IP66, wall, surface mounted, microwave, presence detector, low voltage	
	<b>MWS1A-IP-PRM-VFC</b>	PRM switching, rugged, IP66, wall, surface mounted, microwave, presence detector, volt free contacts	
	<b>MWS1A-PRM</b>	PRM switching, low profile, wall, back box mounted, microwave, presence detector	19
	<b>MWS1A-PRM-LV</b>	PRM switching, low profile, wall, back box mounted, microwave, presence detector, low voltage	
	<b>MWS1A-PRM-VFC</b>	PRM switching, low profile, wall, back box mounted, microwave, presence detector, volt free contacts	

## Minus30 Low Temperature Detector Range

	Order Code	Description	PG
	<b>EBDHS-AD-LT30</b>	1–10V analogue dimming, long range, low temp, IP65, high level, flush mounted, PIR, presence/absence detector, up to 10 drivers/ballasts	12
	<b>EBDHS-DD-LT30</b>	DALI/DSI digital dimming, long range, low temp, IP65, high level, flush mounted, PIR, presence/absence detector, up to 20 drivers/ballasts	
	<b>EBDHS-PRM-LT30</b>	PRM switching, long range, low temp, IP65, high level, flush mounted, PIR, presence/absence detector	
	<b>EBDHS-MB-AD-LT30</b>	1–10V analogue dimming, long range, retrofit, low temp, IP65, high level, luminaire mounted, PIR, presence detector, up to 4 drivers/ballasts	13
	<b>EBDHS-MB-DD-LT30</b>	DALI/DSI digital dimming, long range, retrofit, low temp, IP65, high level, luminaire mounted, PIR, presence detector, up to 10 drivers/ballasts	
	<b>EBDHS-MB-PRM-LT30</b>	PRM switching, long range, retrofit, low temp, IP65, high level, luminaire mounted, PIR, presence detector	
	<b>EBDSPIR-AD-IP-LT30</b>	1–10V analogue dimming, compact, low temp, IP55, ceiling, flush mounted, PIR, presence/absence detector, up to 10 drivers/ballasts	5
	<b>EBDSPIR-DD-IP-LT30</b>	DALI/DSI digital dimming, compact, low temp, IP55, ceiling, flush mounted, PIR, presence/absence detector, up to 20 drivers/ballasts	
	<b>EBDSPIR-PRM-IP-LT30</b>	PRM switching, compact, low temp, IP55, ceiling, flush mounted, PIR, presence/absence detector	
	<b>EBMPIR-MB-AD-LT30</b>	1–10V analogue dimming, miniature, retrofit, low temp, IP65, ceiling, luminaire mounted, PIR, presence detector, up to 4 drivers/ballasts	9
	<b>EBMPIR-MB-DD-LT30</b>	DALI/DSI digital dimming, miniature, retrofit, low temp, IP65, ceiling, luminaire mounted, PIR, presence detector, up to 4 drivers/ballasts	
	<b>EBMPIR-MB-PRM-LT30</b>	PRM switching, miniature, retrofit, low temp, IP65, ceiling, luminaire mounted, PIR, presence detector	



## KNX Presence Detectors

	Order Code	Description	PG
	<b>EBDHS-KNX</b>	KNX, long range, IP65, high level, flush mounted, PIR, presence detector	12
	<b>EBDSPIR-KNX</b>	KNX, compact, IP40, ceiling, flush mounted, PIR, presence/absence detector	5
	<b>MWS3A-KNX</b>	KNX, adjustable head, IP40, ceiling, flush mounted, microwave, presence/absence detector	15
	<b>MWS6-KNX</b>	KNX, compact, IP40, ceiling, flush mounted, microwave, presence/absence detector	17







## Light Level Controls

Order Code	Description	PG
 <b>ALC-PRM-VFC</b>	Compact, IP40, flush mounted, ceiling, photocell switch, PRM switching, volt free contacts	21
<b>ALC-DD</b>	Compact, IP40, flush mounted, ceiling, photocell switch, DALI/DSI digital dimming	
<b>ALC-AD</b>	Compact, IP40, flush mounted, ceiling, photocell switch, 1–10V analogue dimming	

## Infrared Handsets

Order Code	Description	PG
 <b>UHS5</b>	Compact, programming/commissioning handset	4
 <b>UHS7</b>	Compact, user handset	4
 <b>UNLCDHS</b>	Professional, programming/commissioning LCD handset	4

## Accessories

Order Code	Description
 <b>DBB</b>	Surface mount back box*
<b>MWS3A-DBB</b>	MWS3A Surface mount back box BESA fixing**
 <b>DBB-EXT</b>	Surface mount back box extender BESA fixing*
<b>MWS3A-DBB-EXT</b>	MWS3A Surface mount back box extender BESA fixing**
 <b>EBDHS-DBB-WBRKT</b>	EBDHS Wall mount bracket
<b>MWS3A-DBB-WBRKT</b>	MWS3A Wall mount bracket**
 <b>EBD-ENCIP1</b>	IP65 detector enclosure*
 <b>EXD-HSC</b>	Extended wiring compartment for use with flush mounted detectors*
 <b>EBDSPIR-MS</b>	Adhesive masking shields (pack of 10)
<b>EBDHS-MS</b>	Masking shields
 <b>MWS3A-PPPC</b>	MWS3A wall mount protective cover for use with wall mount bracket

\*Compatible with EBDSPIR, EBDHS, ALC, MWS6 and EBDMR presence detectors.

\*\*Also suitable for EBDRC.









CP Electronics  
A business unit of Legrand Electric Limited,  
Brent Crescent,  
London NW10 7XR, UK  
+44 (0)333 900 0671  
info@cpelectronics.co.uk

[www.cpelectronics.co.uk](http://www.cpelectronics.co.uk)

connect with us



A brand of **legrand®**